

data sheet

# 70-600 series

3-way diverter bronze ball valve



### features

- adjustable packing gland
- blowout-proof stem design
- RPTFE seats and stuffing box ring
- drilled and tapped mounting pad
- manufactured in the USA - BABA and BAA compliant

### description

The "Apollo"® 70-600 series standard port 3-way diversion valve is ideal for making tank selection and fluid transfers simpler. Manufactured with proven ASTM materials in the USA.

### size range

- 1/4" - 2"

### connections

- threaded

### configurations

- 70-600 series - standard
- 70-64x series - ss ball & stem

### approvals

- MSS SP-110
- federal specifications
  - WW-V-35C
- CSA B51 CRN:0C10908.5C
- Buy American Act (BAA)
- Build America Buy America (BABA) Act

component	material
body	bronze, ASTM B584-C84400
retainer	B16 or B283, C37700 (1/4" to 1") B584-C84400 (1 1/4" to 2")
ball	brass ASTM B16, C36000 chrome plated brass B283, C37700 chrome plated, or stainless steel, A276-316
seat (2)	RPTFE
stem	brass, ASTM B16, C36000
gland nut	brass, ASTM B16, C36000
stem packing	RPTFE
lever and grip	steel, zinc plated w/ vinyl
lever nut	steel, zinc plated
stem bearing	RPTFE
body seal (1 1/2"-2")	PTFE

### performance rating

CWP	temperature
400 psig (maximum pressure)	500°F (maximum temperature)



this specification is provided for reference only. we reserve the right to change any portion of this specification without notice and without incurring obligation to make such changes to Aalberts integrated piping systems products previously or subsequently sold.

### Aalberts integrated piping systems

10715 Sikes Place / suite 200 / Charlotte / NC / 28277  
aalberts-ips.us

job name	
job location	
engineer	
contractor	
tag	
PO#	
rep	
wholesaler dist	

data sheet

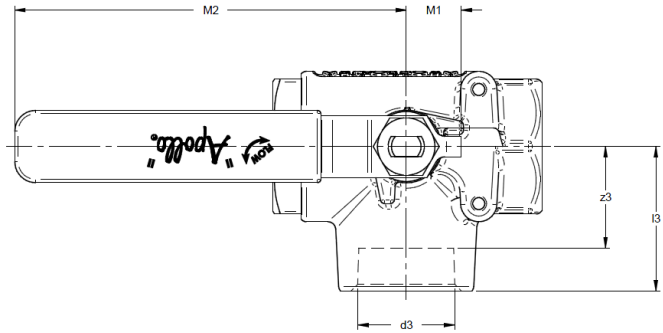
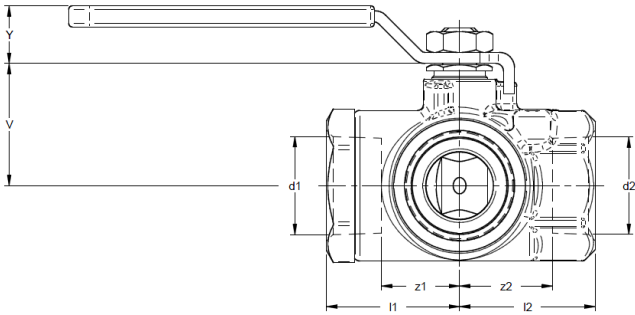

dimensions

part number	size	bore size	d1	d2	l1	l2	z1	z2	M1	M2	V	Y	weight
70-601-01	¼"	0.37"	0.54"	0.54"	1.09"	1.15"	0.69"	0.74"	0.55"	3.85"	1.12"	0.65"	0.86 lbs
70-602-01	⅜"	0.37"	0.68"	0.68"	1.09"	1.15"	0.61"	0.74"	0.55"	3.85"	1.12"	0.65"	0.84 lbs
70-603-01	½"	0.50"	0.84"	0.84"	1.09"	1.15"	0.56"	0.63"	0.55"	3.85"	1.12"	0.65"	0.99 lbs
70-604-01	¾"	0.68"	1.05"	1.05"	1.47"	1.49"	0.92"	0.89"	0.67"	4.76"	1.39"	0.68"	1.91 lbs
70-605-01	1"	0.87"	1.32"	1.32"	1.61"	1.64"	0.94"	1.12"	0.67"	4.76"	1.78"	0.68"	2.42 lbs
70-606-01	1 ¼"	1.00"	1.66"	1.66"	2.00"	1.98"	1.37"	1.40"	0.98"	5.40"	1.99"	0.70"	4.27 lbs
70-607-01	1 ½"	1.25"	1.90"	1.90"	2.19"	2.20"	1.55"	1.52"	0.98"	5.40"	2.18"	0.70"	5.82 lbs
70-608-01	2"	1.50"	2.38"	2.38"	2.35"	2.32"	1.75"	1.73"	0.98"	5.40"	2.37"	0.70"	8.55 lbs

options

option	component	size
(-04)	2 ¼" cs stem extension	¼" - 2"
(-10)	ss lever & nut	¼" - 2"
(-17)	rough chrome plated	¼" - 2"
(-21)	UHMWPE trim (non-PTFE)	¼" - 2"
(-27)	ss latch-lock lever & nut	¼" - 2"
(-35)	VTFE trim	¼" - 2"
(-56)	MPTFE seats & packing	¼" - 2"
(-57)	oxygen cleaned	¼" - 2"
(-T01)	BSPT (tapered) thread	¼" - 2"

data sheet

flow characteristics

graph 1

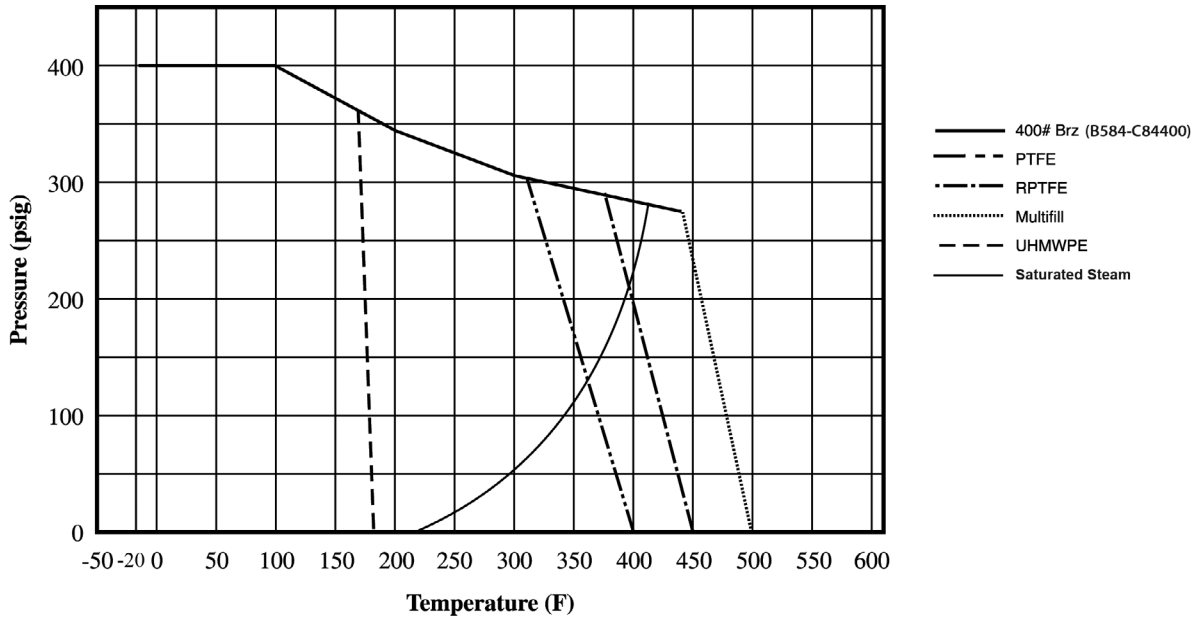

flow pattern

